

SIZE		d	n	L	H1	H2	H3	D1	D2	D3	S	WEIGHT (kg)		
inch	mm											BVHBN	BVHBWN	BVHBPTN
1/2B	15A	14.5	Rc 1/2	56	50	50	43	85	75	66	27.5	0.30	0.30	0.30
3/4B	20A	19.5	Rc 3/4	65	53	53	46	85	75	66	33.5	0.45	0.45	0.45
1B	25A	24.5	Rc 1	77	59	58	57	115	95	86	41	0.70	0.70	0.70
1 1/4B	32A	31.5	Rc 1 1/4	90	64	63	62	115	95	86	51	1.10	1.10	1.10
1 1/2B	40A	39.5	Rc 1 1/2	98	74	75	75	130	120	111	58	1.75	1.70	1.70
2B	50A	49.5	Rc 2	119	81	82	82	130	120	111	71	2.85	2.80	2.80

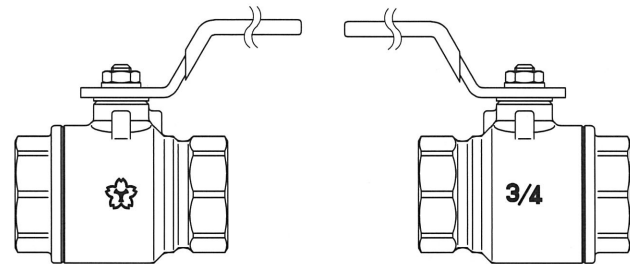

Marking (Ex. 3/4 B)

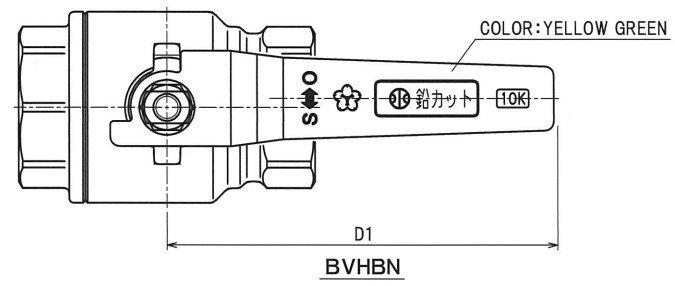

BVHBN

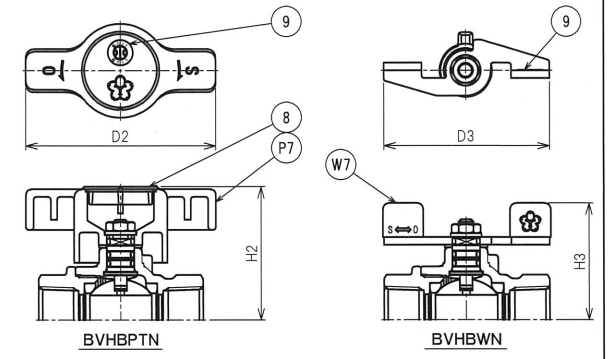
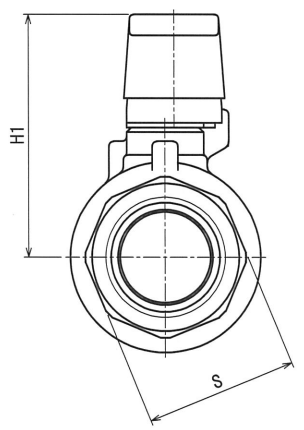
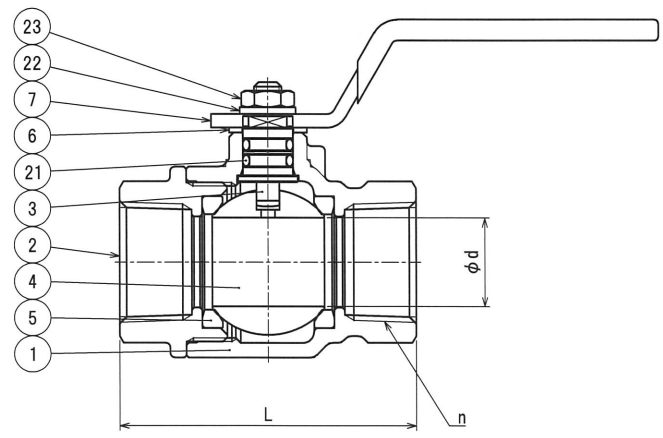

23	HEXAGON NUT	SUS304	1	
22	SPRING LOCK WASHER	SUS304	1	
21	O-RING	FKM	2	
9	LABEL	PES	1	
8	HANDLE CAP	PP	1	COLOR:ORANGE
W7	WING HANDLE	SUS304	1	VINYL COATING COLOR:ORANGE
P7	T HANDLE	PA	1	COLOR:WHITE
7	LEVER HANDLE	SUS430	1	VINYL COATING COLOR:YELLOW GREEN
6	WASHER	PTFE	1	
5	BALL SEAT	PTFE	2	
4	BALL	SUS304	1	
3	STEM	NBY	1	Dezincification resistant brass
2	CAP	CAC406	1	
1	BODY	CAC406	1	

No.	Name of Parts	Materials	Q'ty	Descriptions
PRESSURE INSPECTION				
		DELIVERY INSPECTION (INSPECTION)	FORM INSPECTION (TEST)	
BODY		0.60 [MPa] (Air)	2.10 [MPa] (Water)	
SEAT		0.60 [MPa] (Air)	1.54 [MPa] (Water)	

LEAD-CUT 10K BRONZE BALL VALVE
FULL BORE, SCREWED END TYPE

FIGURE
BVHB
BVHBPTN, BVHBWN

Approval	Check	Drawing	Date	Scale
		T.Nishikawa	2022.02.18	